

Lifting

Lifting Points—Twin-Post Hoist



CAUTION: Do not allow the hoist adapters to contact the steering linkage, suspension arms, stabilizer bar, rear subframe stabilizer brackets or to compress the lower suspension arm stabilizer bar insulator. Damage to the suspension, exhaust and steering linkage components may occur if care is not exercised when positioning the hoist adapters of two-post hoists prior to lifting the vehicle.



CAUTION: Never use the rear axle as a lift point. Damage to the rear axle seals and bushes may occur.



CAUTION: When using a twin post hoist, a cushioned pad must be utilized to avoid body damage.

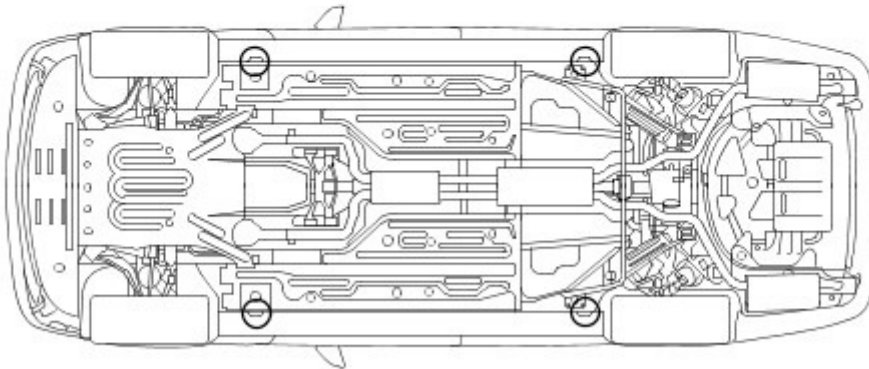
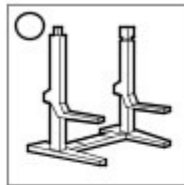

E36993

Lifting Points—Floor Jack and Axle Stands



CAUTION: If the vehicle is to be lifted using floor jacks, two jacks must be used to raise either the front or rear of the vehicle. If one jack only is used, excessive body twist may occur.



CAUTION: When using a floor jack to jack up the rear of the vehicle, the jack head must be aimed at the NVH bar securing bolts to avoid fuel tank damage or body damage.



CAUTION: When using a floor jack, a cushioned pad must be utilized to avoid body damage.



CAUTION: When using axle stands, a cushioned pad must be utilized to avoid damage to the body or rear subframe assembly.

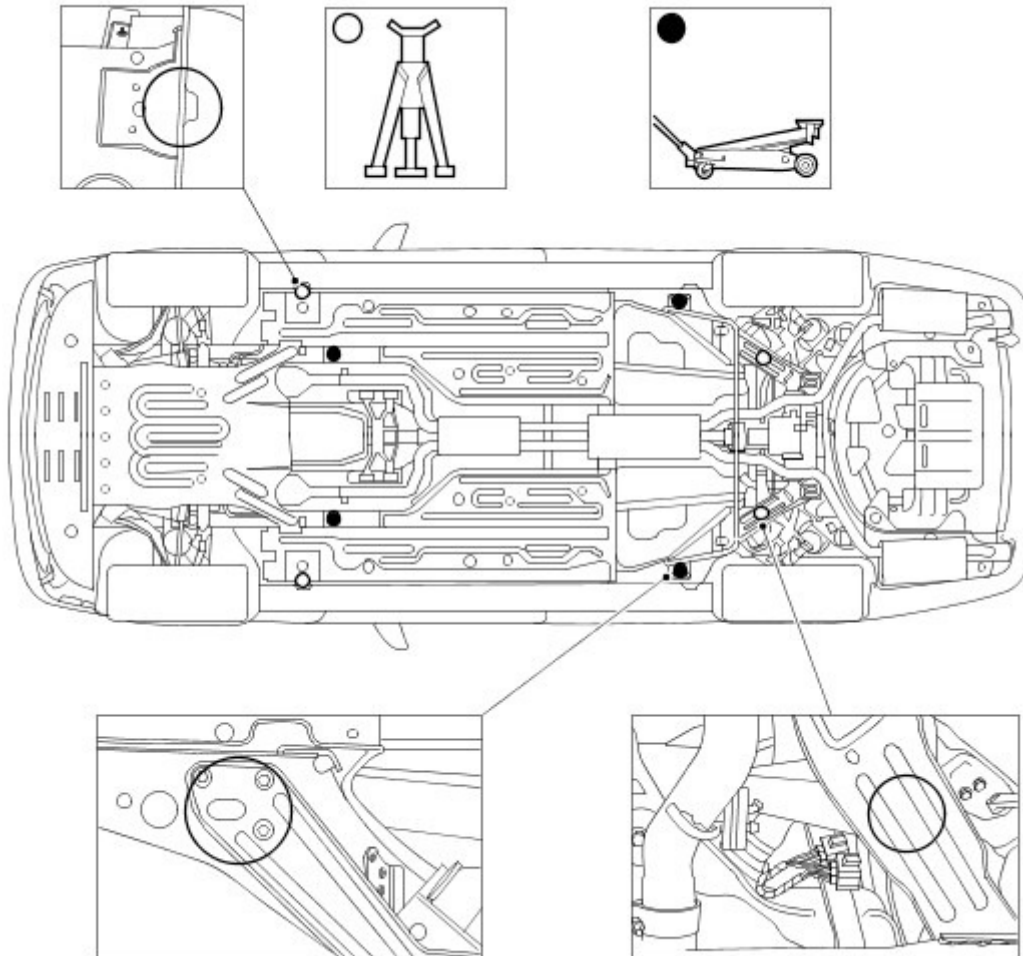

E37355

Vehicle Recovery

NOTE:

Prior to vehicle recovery, make sure the vehicle keys are available and the security system is disarmed.

Vehicle recovery methods are:

- By flat-bed transporter.
- By rear suspended tow.

Transporter or Trailer Recovery

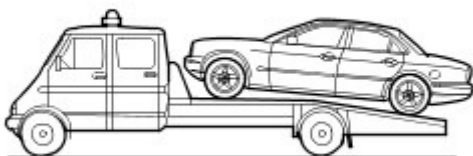

E36585

When the vehicle is being recovered by transporter or trailer:

- the parking brake must be applied and the wheels chocked.
- the gear selector lever must be in Neutral. Do not select Park on automatic transmission vehicles, as the

- parking lock mechanism may be damaged by the forward and backward rocking motion of the vehicle.
- the vehicle must be securely tied down to the transporter or trailer.

Rear Suspended Tow

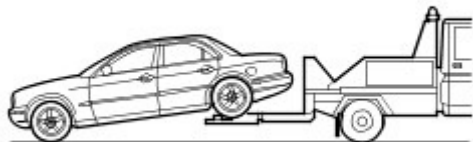

E36586

When the vehicle is being recovered by rear suspended tow:

- the ignition key must be removed from the ignition switch to lock the steering.
- the rear wheels must be correctly positioned in the lifting cradle and securely tied down.

Emergency Towing



WARNING: If the engine is not running, the steering will become heavy and the force necessary to effectively apply the brakes will be greatly increased.



CAUTION: A vehicle with a defective transmission must be towed by rear suspended tow.

When the vehicle is being towed on its own wheels:

- Local regulations for the towing of vehicles must be followed. In some countries the registration number of the towing vehicle and an 'On Tow' sign or warning triangle must be displayed at the rear of the towed vehicle.
- The gear selector lever must be in Neutral.
- The ignition switch must be in position II to release the steering lock and make the direction indicators, horn and stop lamps operate.
- A distance of 0,8 km (0.5 mile) must not be exceeded.
- A speed of 48 km/h (30 mph) must not be exceeded.
- The tow rope must be attached to the front towing eye.